

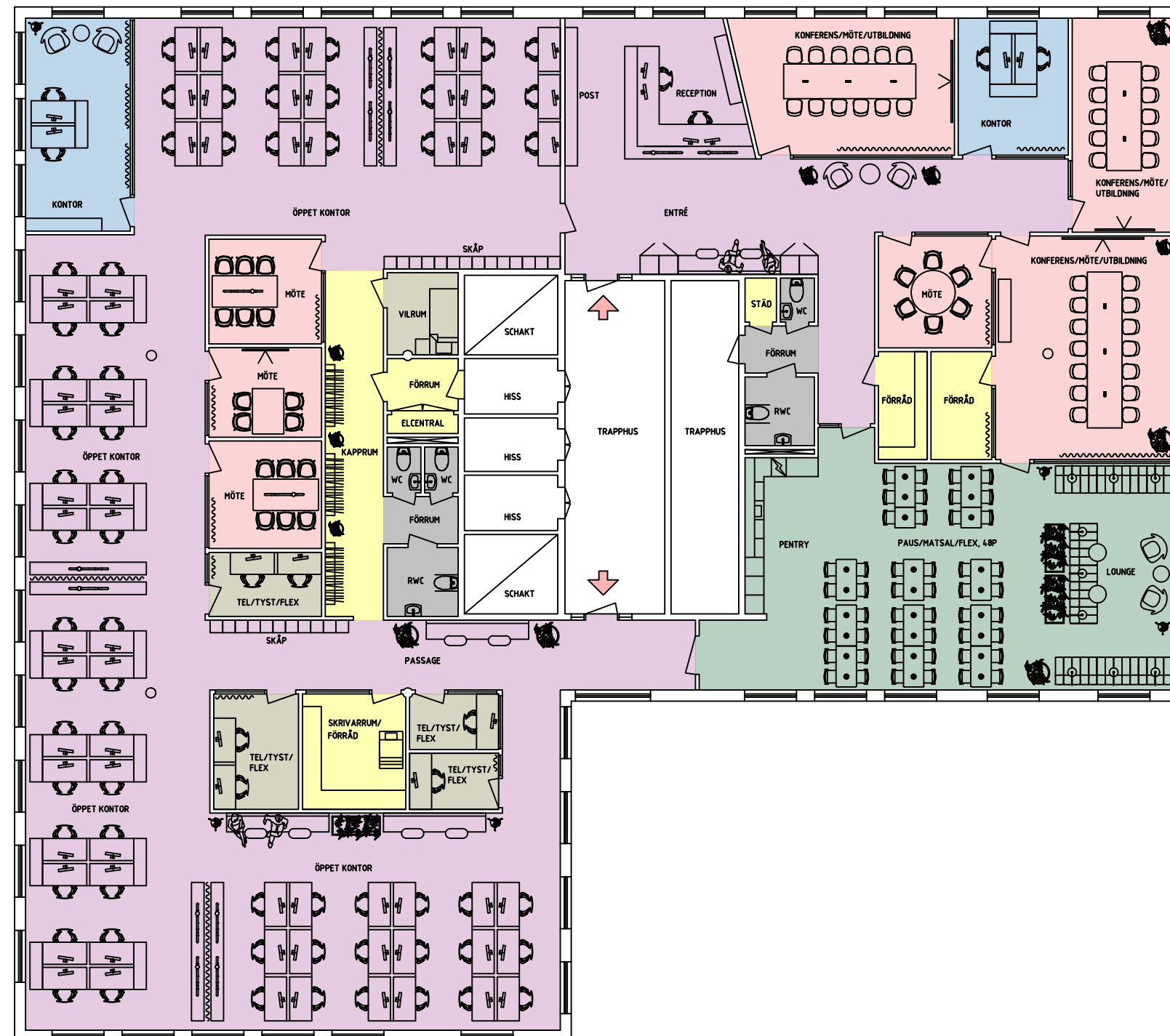







KONTORSLOKAL - NELLICKEVÄGEN 20-22, GÖTEBORG - 865 KVM - PLAN 9

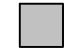

ANTAL KVADRATMETER: 865 KVM
 ANTAL VÅNINGSPÅN: 1ST
 ANTAL ARBETSPLATSER (FASTA): 73ST
 ANTAL ARBETSPLATSER (FLEXIBLA): 54ST
 ANTAL MÖTE/KONFERENS-RUM: 7ST
 ANTAL MÖTESPLATSER/LOUNGE: 4ST
 ANTAL PENTRY/KAFFEBAR: 1ST

ANTAL TYSTA/TEL-RUM: 4ST
 ANTAL VILRUM: 1ST
 ANTAL WC: 5ST
 ANTAL FÖRRÅD/STÄD/PRINTER: 5ST
 MATSAL/PAUS: 1ST

	ÖPPET KONTOR		SKRIVARRUM/FÖRRÅD/KAPPRUM
	MÖTESRUM		PENTRY/PAUS/KAFFEBAR
	TYSTA RUM/VILRUM		WC/DUSCH/STÄD
	KONTOR		TRAPPHUS/HISS



0 1 2 3 4 5 METER

